

Model 1667 Heavy Duty Single Point Load Cells

Features

- parallel bending beam
- heavy duty
- capacity: 50, ..., 2000 kg
- accuracy: 0.02 %fs; option: OIML C3
- max. platform size: 1200 X 1200 mm
- aluminum construction with surface anodized
- environment protection class: IP 65

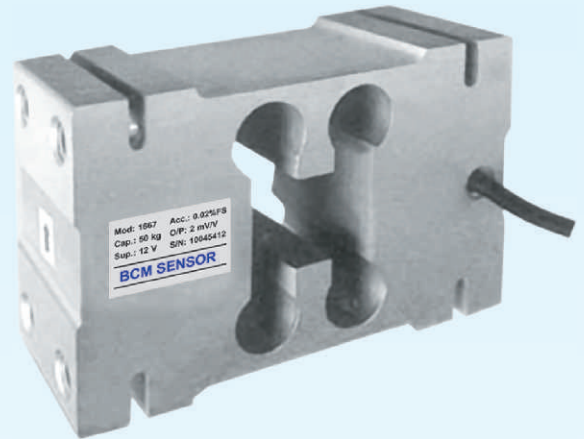

Applications

- counting scales
- hopper scales
- overhead track scales

suggested platform size:

50~200kg:	600 mm x 600 mm
250~500kg:	600 mm x 800 mm
750~2000kg:	1200 mm x 1200 mm

Description

The "single point" load cells are made of parallel bending beam working principle. Only one unit is sufficient to build up a scale. These load cells are moment insensitive. That is, when installed in a platform scale, it reads the same regardless of the position of the load applied to the upper platform.

Model 1667 load cells are designed to this "single point" type and are manufactured from high quality aluminum alloy of aviation standard. 1667 load cells can be used to measure loads ranging from 50 kg to 2000 kg with the measuring accuracy of 0.02%fs (fs = full scale). On request, 1667 load cells can be supplied with OIML C3 certificate.

1667 load cells are widely used to manufacture hopper scales, track scales and counting scales.

Dimensions

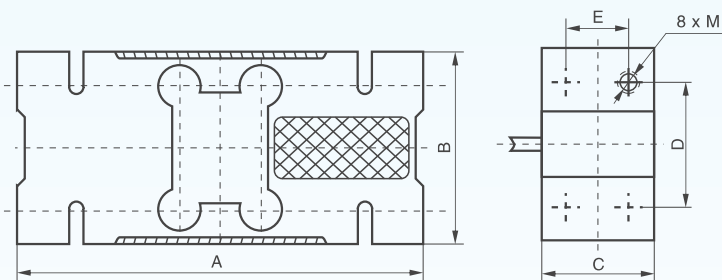

Capacity(kg)	A	B	C	D	E	M
50~200	156	75	44	50	24	M12-7H
300, 500	146	95	60	70	36	M12-7H
1000, 2000	176	125	76	95	46	M16-7H

Electrical connection

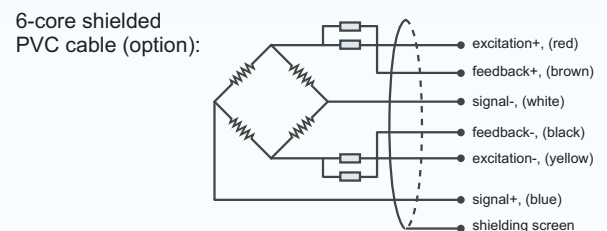
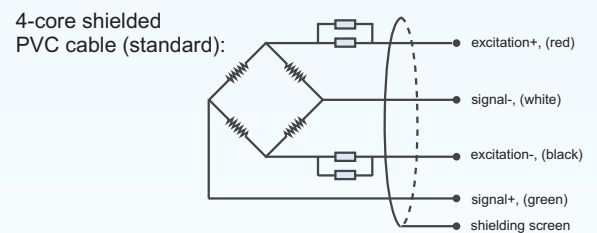

Model 1667

Heavy Duty Single Point Load Cells



Technical Data

parameters	units	specifications
capacity	kg	50, 70, 100, 200, 300, 500, 700, 1000, 2000
safe load limit	%fs	120
ultimate overload	%fs	150
output sensitivity at fs	mV/V	2.0 ± 0.1
zero unbalance	%fso	± 1.5
accuracy class according to OIML R60		C3
max. number of verification interval (n _{max})		3000
min. load cell verification interval (V _{min})		7000
combined error	%fs	± 0.02
creep error (30 min.)	%fs	± 0.02
excitation (supply voltage)	Vdc	10 (recommended), 9, ..., 12
max. excitation voltage	Vdc	15
input resistance	Ω	410 ± 10
output resistance	Ω	350 ± 10
insulation resistance	MΩ	≥ 5000@50 Vdc
storage temp. range	°C	-35 ~ +80
operating temp. range	°C	-20 ~ +65
compensated temp. range	°C	-10 ~ +40
temp. coefficient of sensitivity	%fs/°C	± 0.002
temp. coefficient of zero	%fs/°C	± 0.002
load cell body material		aluminum alloy
sealing		potted
mechanical interface		refer to the dimensions on the datasheets
electrical interface		Φ5 mm, 4-conductor shielded, PVC jacket, 3 m length Φ6.2 mm, 6-conductor shielded, PVC jacket, 3 m length
environment protection		IP 65
unit weight	kg	~0.9 (cap.<300kg), ~1.7 (cap.=300&500kg), ~3.6 (cap.>500kg)

The listed specifications are subject to change without prior notice.

BCM SENSOR TECHNOLOGIES BVBA

Model 1667 Heavy Duty Single Point Load Cells



Ordering Information

position (pos.) 1: model									
1667: made from aluminum alloy									
pos. 2: capacities									
50 kg		100 kg		1000 kg					
70 kg		200 kg		2000 kg					
		300 kg							
		500 kg							
		700 kg							
pos. 3: output sensitivity									
2 mV/V									
pos. 4: non-linearity or accuracy class									
0.02 %fs (standard)				OIMLC3					
pos. 5: bridge resistance									
350 Ω (R _{in} = 410±10Ω, R _{out} = 350±10 Ω)									
pos. 6: threads (live end/fixed end)									
4xM/4xM* : four M threads at the live end, four M threads at the fixed end									
pos. 7: electrical interface									
cable, code = diameter(Φ)/number of conductors/cable jacket/cable length									
5/4/PVC/3 = Φ5 mm, 4-conductors shielded, PVC, length = 3** m									
6.2/6/PVC/3 = Φ6.2 mm, 6-conductors shielded, PVC, length = 3** m									
pos. 8: environment protection									
IP 65									
pos. 9: accessories for installation									
NA**. In case of "NA", pos.9 can be omitted.									
pos. 10: customized spec's									
When any customized spec's are required, the customer needs to add "C" as the last parameter in the ordering code, and specifies the wished spec's on his order clearly.									
The customized spec's needs to be confirmed in advance by BCM's sales representative.									
Code "C" can be omitted if no customized spec's are required.									
pos.1	pos. 2	pos. 3	pos. 4	pos. 5	pos. 6	pos. 7	pos. 8	pos. 9	pos. 10

*: refer to the dimensions on the datasheets for the M thread size.

** : This value can also be a customized value.

***: NA = not available or not applicable

example: 1667-500kg-2mV/V-0.02%fs-350Ω-4xM12/4xM12-6.2/6/PVC/3-IP65-C



BCM SENSOR TECHNOLOGIES BVBA

ISO9001 Certified Company

Industriepark Zone 4, Brechtsebaan 2
B-2900 Schoten - Antwerpen, BELGIUM

Tel.: +32-3-238 6469
Fax: +32-3-238 4171

website: www.bcmsensor.com
email: sales@bcmsensor.com